

LiteBoard



86X1EE

86" ADVANCED INTERACTIVE DISPLAY

The new 86X1EE uses a true operating system-free design to ensure the security of your information, making it simple and easy to operate. It seamlessly interfaces with computer modules, providing large interactive display services for both Google and Windows platforms.

Highlights



Secure

True operating system-free design to ensure the security of your information



Energy Saving

Energy Star 8.0 Certificate, energy-saving and eco friendly.



Zero Bonding

Zero Bonding, no floating feeling when writing, dust proof and waterproof, high reliability and offering excellent writing and viewing experiences



Simple and Easy to Use

With OS-free, simple and easy to use, no learning curve. In any signal source, you can use the five-finger menu for easy operation, and it supports RS232 serial port control function. This simple operation design enables users to use the product more conveniently and efficiently.

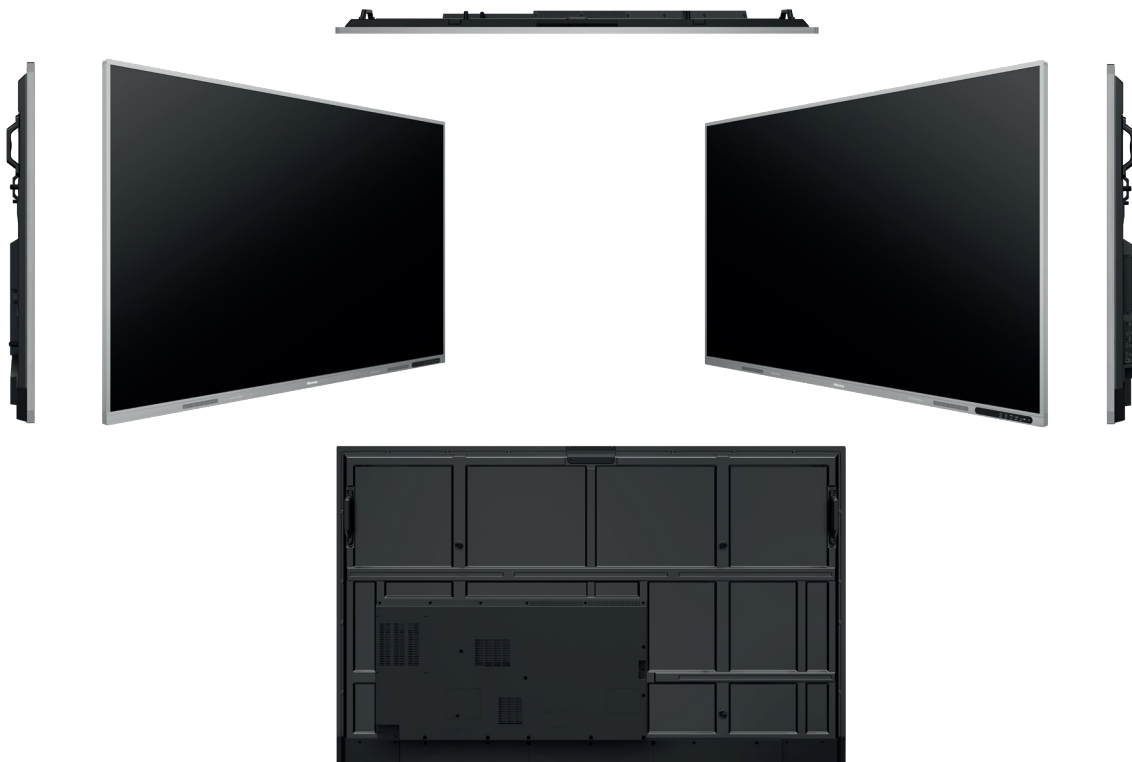

Specifications

Interactive Digital Board

LCD Size	86"
Backlight Type	D-LED
Panel Type	86":VA
Resolution	3840x2160(pixels)
Brightness	400nits(typ.)
Contrast Ratio	4000:1(typ.)
Response Time	8ms (typ.)
Refreshing Frequency	60Hz
Viewing Angle	178°(H) / 178°(V)
Lifetime(typ.)	50,000 hrs
Color Gamut(X% NTSC)	72%
Display Colors	1.07B(10bit)

System

CPU	Architecture - 32bits RISC CPU - 8031 CPU for STB Working Frequency - 633MHz
GPU	N/A
RAM	64MB
ROM	8MB
OS	N/A
Language	English (default), Chinese, French, Spanish, German, Italian, Polish, Finnish, Norwegian, Swedish, Thai, Indonesian, Japanese, Russian, Vietnamese

Power

Power Requirements	AC 100 V ~ 240 V, 50/60 Hz
Power Consumption(Max.)	430W (Max)
Power Consumption(Typ.) Without OPS	226.7WTyp. <0.5W
Speaker	Built in speaker - 2 x 15W External - /
OPS Power	DC 18V / 5A

Physical

Product Size (W x H x D)	1954.2 x 1151.1 x 98mm 77 x 45.3 x 3.8 inch
Package Size (W x H x D)	2095 x 1283 x 240mm 82.5 x 50.5 x 9.4 inch
Net Weight	54.5kg / 120.1lbs
Packed Weight	72.5kg / 159.8lbs
Housing Material	Front Shell: Aluminium Rear Shell: Plastic
Housing Colour	Black + Tarnish
VESA	1000 x 600mm, 4-M8 Screw

Connectivity

Wi-Fi	N/A
Bluetooth	N/A
NFC	No
Camera	No
Input	HDMI(2.0) IN - x3 DP(1.2a) IN - / VGA IN - / Mic IN - / OPS(Optional) - x1 LAN - / USB2.0 - x1 USB3.0 - x1 Type-C - x1 Audio IN - N/A RS232 IN - x1 (RJ45) Service - x1
Output	RS232 OUT - N/A HDMI OUT - / AV OUT - / S/PDIF - / Touch - x2 Audio OUT - x1

Touch

Sensing Type	Infrared Touch Frame
Surface Protection	Anti-Glare Glass
Infrared Touch	≤40 points
Touch Accuracy	90%(±1mm)
Theory Clicks	Unlimited
Minimum Touch Object	≥2mm
Writing Height	≤3mm (Ssport Quatro Sense)
Windows 10/8/7,Android	Multi Touch

Certification

Standard Certification	CB/CE/ERP/SouthAfrica Energy Efficiency/eTUVus/CEC/FCC/UKCA/ Energy Star
------------------------	--



Dimensions

86" 1954.2^W x 1151.1^H x 98^D mm / 77 x 45.3 x 3.8 inch
54.5 kg / 120.1 lbs

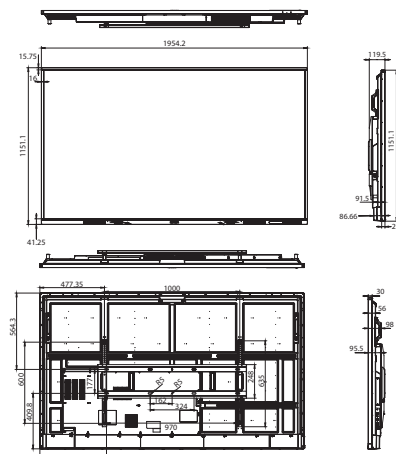

Product specifications may vary per region, and specifications are subject to change. This material may include corporate names and trademarks of third parties which are the properties of the third parties respectively.